







BPX 120 · BPX 140

LOW PRESSURE DIAPHRAGM PUMPS / POMPE A MEMBRANA A BASSA PRESSIONE

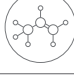

HIGHLIGHTS

	20 bar 290 p.s.i.
	117 - 136 l/min 31,0 - 36,0 US gpm
	550 rpm
	6,1 - 6,9 HP 4,5 - 5,1 kW
	Polyamide Poliammide
	NBR Standard DESMOPAN Standard VITON On request
	Standard Di serie

FEATURES

Configuration: 3 diaphragms in NBR and Desmopan® (Viton available on request). Parts in contact with spray liquid: polyamide. Standard: pressure damper, thrust bearings, antifreeze outlet. On request: safety valve.

CARATTERISTICHE

Configurazione: 3 membrane in NBR e Desmopan® (Viton a richiesta). Parti a contatto con il liquido: poliammide. Di serie: accumulatore di pressione, cuscinetti reggispinta, scarico antigelo. A richiesta: valvola di sicurezza.

BENEFITS

1. Excellent priming and displacement capacity.
2. Silent and smooth operation thanks to the innovative design of the new check valves.
3. Extreme chemical resistance.
4. Highest resistance to axial and radial thrust.

BENEFICI

1. Eccellente capacità di adescamento e rendimento volumetrico.
2. Funzionamento silenzioso e regolare grazie al design innovativo delle valvole.
3. Estrema resistenza chimica.
4. Massima resistenza alla spinta assiale e radiale.

APPLICATIONS · APPLICAZIONI



Boom sprayers
Irroratrici a barra

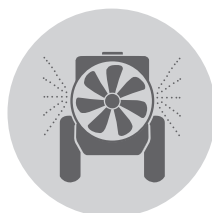

Air blast sprayers
Atomizzatori



Spot spraying
Irrorazione localizzata



De-icing
De-icing

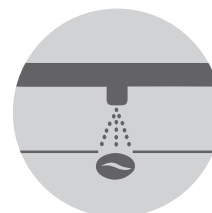

Fert injection
Iniezione fertilizzanti



Suction
Aspirazione

Ø 35 (BPX 120)
Ø 40 (BPX 140)



Delivery
Mandata

Ø 20

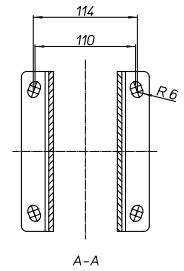
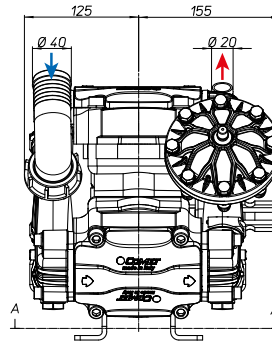
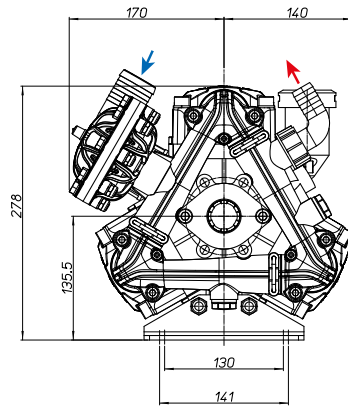

TECHNICAL FEATURES · CARATTERISTICHE TECNICHE

BPX 120	0 bar - 0 p.s.i.				5 bar - 72 p.s.i.				10 bar - 145 p.s.i.				15 bar - 217 p.s.i.				20 bar - 290 p.s.i.				kg lb	
	RPM	l/min	U.S.g.p.m.	HP	kW	l/min	U.S.g.p.m.	HP	kW	l/min	U.S.g.p.m.	HP	kW	l/min	U.S.g.p.m.	HP	kW	l/min	U.S.g.p.m.	HP		
400	86	22,7	0,4	0,3	85	22,4	1,5	1,1	84	22,2	2,4	1,8	83	22,0	3,2	2,4	82	21,6	4,0	3,0	14,3	32
450	97	25,7	0,6	0,5	96	25,4	1,6	1,2	95	25,1	2,8	2,0	94	24,8	3,6	2,7	93	24,5	4,7	3,5		
500	107	28,4	0,8	0,6	107	28,1	2,0	1,5	106	27,9	3,2	2,4	104	27,5	4,2	3,1	103	27,2	5,5	4,1		
550	117	31,0	1,0	0,7	116	30,7	2,2	1,6	115	30,4	3,6	2,7	114	30,2	4,8	3,5	113	29,9	6,1	4,5		

BPX 140	0 bar - 0 p.s.i.				5 bar - 72 p.s.i.				10 bar - 145 p.s.i.				15 bar - 217 p.s.i.				20 bar - 290 p.s.i.				kg lb	
	RPM	l/min	U.S.g.p.m.	HP	kW	l/min	U.S.g.p.m.	HP	kW	l/min	U.S.g.p.m.	HP	kW	l/min	U.S.g.p.m.	HP	kW	l/min	U.S.g.p.m.	HP		
400	100	26,5	0,4	0,3	98	25,9	1,6	1,2	97	25,6	2,5	1,9	96	25,3	3,7	2,7	95	25,0	5,0	3,7	14,3	31,5
450	113	29,8	0,6	0,5	110	29,0	1,8	1,3	108	28,5	2,9	2,1	107	28,3	4,0	3,0	106	28,0	5,2	3,8		
500	125	33,1	0,8	0,6	122	32,3	2,2	1,6	121	31,9	3,6	2,7	120	31,6	5,0	3,7	117	31,0	5,7	4,2		
550	136	36,0	1,0	0,7	135	35,8	2,3	1,7	133	35,1	3,7	2,7	132	34,9	5,2	3,8	130	34,4	6,9	5,1		

AVAILABLE VERSIONS · VERSIONI DISPONIBILI

A BLANK - 1" 3/8 M
CHIUSO - 1" 3/8 M

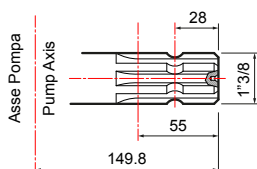

B BLANK - Ø 30
CHIUSO - Ø 30

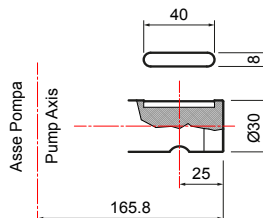

C Ø 20 - 1" 3/8 M

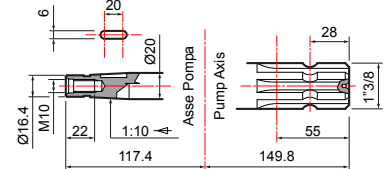

PUMPS AND IMPLEMENTS · POMPA E APPLICAZIONI

IMPLEMENTS · APPLICAZIONI	DRIVE-SHAFT TYPE · TIPO DI ALBERO Pump code · Codice pompa	IMPLEMENTS · APPLICAZIONI
---------------------------	---	---------------------------



BLANK - 1" 3/8 M
CHIUSO - 1" 3/8 M



NBR **BPX 120**
30088-00003
with feet / con piedi

D **BPX 120**
30088-00007
with feet / con piedi

NBR **BPX 140**
30085-00001
with feet / con piedi

D **BPX 140**
30085-00006
with feet / con piedi

	Hydraulic motor adapter Adattatore per motore idraulico
Ø 1" cyl. shaft 6,35 mm key Albero cilindrico Ø1" con linguetta 6,35 mm	10001-00615
Ø 25 mm cyl. shaft 8 mm key Albero cilindrico Ø 25 mm con linguetta 8 mm	10001-00614
	Drive-shaft guard Protezione cardano UNI EN ISO 4254
	10002-01781



BLANK - Ø 30
CHIUSO - Ø 30



NBR **BPX 120**
30088-00004
with feet / con piedi

D **BPX 120**
30088-00008
with feet / con piedi

NBR **BPX 140**
30085-00003
with feet / con piedi

D **BPX 140**
30085-00005
with feet / con piedi

	Gas engine gearboxes Riduttori per motore a scoppio
Extension 3 (SAE J 609 a) R.R: 1 : 6,44 - 3600 rpm	10001-04698
Extension 4 (SAE J 609 a) R.R: 1 : 6,44 - 3600 rpm	10001-04699
	Gearbox for electric motor Riduttore per motore elettrico
Gr. 100-112 (Hz 50 - 2 poles / pol) R.R. 1 : 5,09 - 2800 rpm	10001-04700

	Adapter on conical through shaft Adattatore su albero passante conico
1" 3/8 M - Ø 20	10001-04584
	Adapter for pulley Adattatore per puleggia
Ø 25 - Ø 20	10001-04587



Ø 20 - 1" 3/8 M



NBR **BPX 120**
30088-00005
with feet / con piedi

D **BPX 120**
30088-00006
with feet / con piedi

NBR **BPX 140**
30085-00004
with feet / con piedi

D **BPX 140**
30085-00007
with feet / con piedi

SAFETY VALVES · VALVOLE DI SICUREZZA

**Not included
Non inclusa**

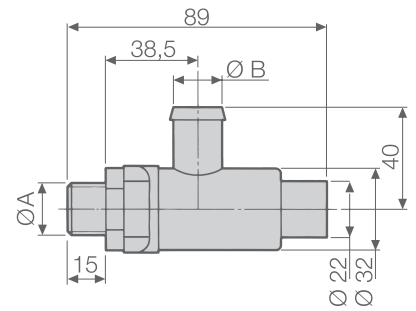

PUMPS POMPE	PART NUMBER CODICE	TECHNICAL FEATURES · CARATTERISTICHE TECNICHE			
		Ø A	Ø B mm (in)	PRESSURE PRESSIONE bar (p.s.i.)	Color Colore
BPX 120	10002-01456	G 3/8	13 (0,51)	20 (290)	Green - Verde
BPX 140					

MAINTENANCE SET · KIT MANUTENZIONE



SERIES SERIE	MODEL MODELLO	PART NUMBER CODICE	DIAPHRAGM TYPE TIPOLOGIA MEMBRANA
BPX	120 140	10001-12851	NBR
		10001-13749	DESMOPAN

DIAPHRAGMS · MEMBRANE

	MATERIAL · MATERIALE		
	NBR	D	V
Pump diaphragm Membrana pompa	00006-00002	00006-00092	00006-00027
Pressure damper diaphragm Membrana accumulatore di pressione	00006-00028	00006-00095	00006-00106 00006-00109